

## RF 15, gold, non-illuminated, 2,9<sup>±0,6</sup> N, bezel transparent, 1 NO



### fields of application

- Measurement-control-regulation
- Mechanical and system engineering
- Automotive
- Electro-medical

### special features

- Gold contacts, reliable switching with low currents
- Optional: spot illumination or full illumination
- Key grid 19.05 mm
- Overall height: 9.7 mm or 12.5 mm with keycap
- Terminal technology: THT



## description

The RF 15 gold tactile switches have a 15 x 15 mm edge length, reliable gold contacts and a noticeable click. They are used in flat data entry keyboards under overlays or under keycaps, such as RAFI RK 90 keycaps.

Flat data entry keyboards with RF 15 elements should be constructed in a 19.05 mm grid. With this grid, strips of glue remain between the individual keys on the front panel. The overlay, which we recommend embossing above the key switches, can be glued onto these strips of glue.

Wenn Wechselbeschriftungen benötigt werden, oder wenn die Bauhöhe von 12,5 mm erreicht werden soll, kann auf die unbeleuchteten Tasten eine Tastenkappe aufgerastet werden. Die Beschriftung der Tastenkappe wird durch ein Fenster in der Dekorfolie sichtbar. Für einen Beschriftungswechsel kann die Tastenkappe ausgetauscht werden.

## technical data

### ➤ general

illuminated	No
Bezel color	transparent
Operating temperature, min.	-25 °C
Operating temperature, max.	70 °C
Storage temperature, min.	-25 °C
Storage temperature, max.	70 °C
Soldering time for manual soldering, max.	5 sec
Soldering temperature for manual soldering	350 °C
Soldering temperature for wave soldering	260 °C
Soldering	Manual / wave
Packaging	Tube

### direct links

- [RAFI eCatalog](#)

Packaging unit	32 pcs.
net weight	2.5 g
standard delivery time	3 weeks
Operating life	1,000,000 Cycles
B10	1,300,000 Cycles
RoHS compliant	Yes
REACH compliant	Yes
Solder heat resistance according to standard	DIN EN 60068-2-20
MOQ order	32
<b>&gt; mounting diameters</b>	
Installation height	9.7 mm
Grid, min.	19.05 mm
Outside dimension, length	15 mm
Outside dimension, width	15 mm
Outside dimension, height	9.7 mm
<b>&gt; mechanical data</b>	
Actuation function	momentary contact function
Operating force, max.	100 N
Operating force, min.	2,9 $\pm$ 0,6 N
Switching travel	0,5 $\pm$ 0,2 mm
Contact function	1 NO
Contact system	Snap-action contact
Contact material	Gold
Fixing	Soldering
Terminal on the rear	THT
Lötbarkeit	Yes
<b>&gt; electrical data</b>	
Rated voltage, min.	0.02 V
Rated voltage, max.	35 V
Rated current, min.	0.00001 A
Rated current, max.	0.1 A
Rated power, max.	2 W

## Dimensioned drawing

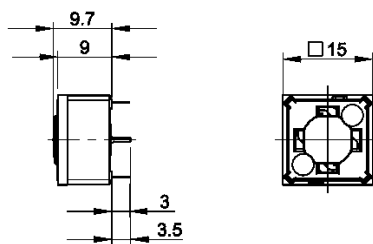

Technical drawing of a square plate with the following dimensions:

- Width: 15.00
- Height: 6.35
- Thickness: 1.778
- Hole diameter:  $\varnothing 1.10 \pm 0.10$

### front panel drawing

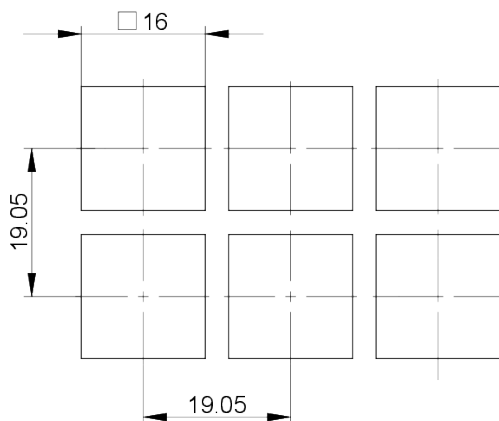

Technical drawing showing a cross-section of a control panel assembly. The drawing includes dimensions and labels for various components:

- RF15 mit aufgerasterter Tastenkappe (ohne Folie)**: RF15 with perforated keycap (without foil)
- RF15 Kurzhubtaster**: RF15 short-throw switch
- RF15 Leuchtfeld**: RF15 light field
- RF15 Kurzhubtaster beleuchtet**: RF15 short-throw switch with light
- Folie**: Foil
- Frontplatte**: Front plate
- Distanzbuchse**: Spacer bush
- Leiterplatte**: PCB
- Prägehöhe**: Pre-raise height
- 16**: Dimension (width)
- 15**: Dimension (width)
- 0,35**: Dimension (thickness)
- 12±0,1**: Dimension (height)
- 8,25±0,1**: Dimension (height)
- 19,05**: Dimension (width)
- 19,05**: Dimension (width)
- Bis Oberkante Frontplatte**: Up to top edge of front plate
- Bis Oberkante Frontplatte**: Up to top edge of front plate

### front panel drawing

