

Data Sheet | Item Number: 2059-302/998-403
SMD PCB terminal block; 0.5 mm²; Pin spacing 3 mm; 2-pole; PUSH WIRE®; in tape-
and-reel packaging; 0,50 mm²; white
<https://www.wago.com/2059-302/998-403>

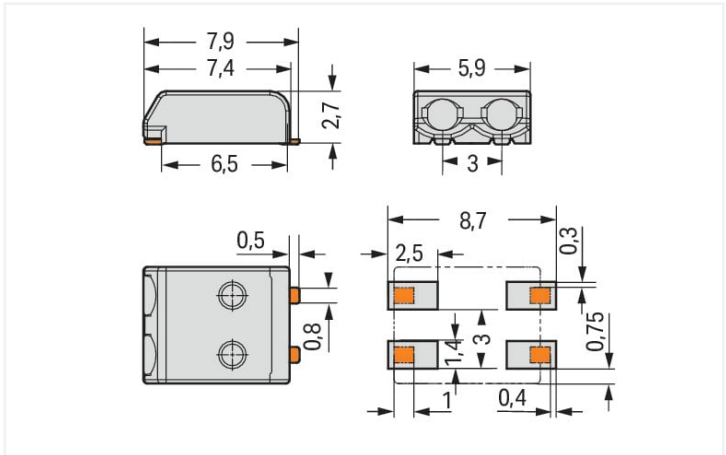

Color:  white



Dimensions in mm

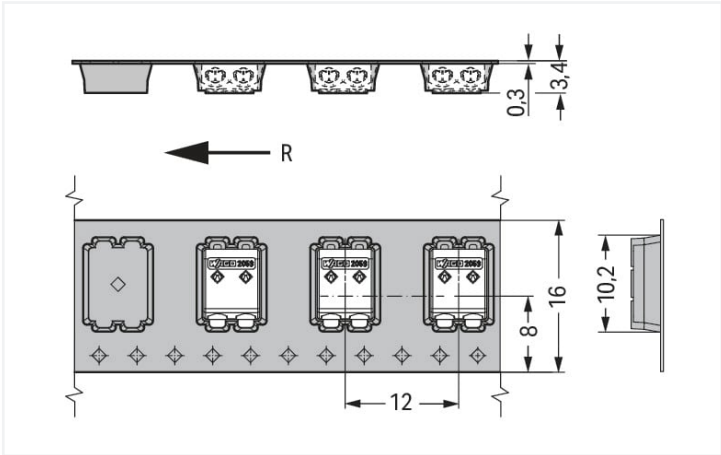

Dimensions in mm
R = feed direction

- SMD PCB terminal blocks with PUSH WIRE® connection technology
- Push-in termination of solid conductors
- Easy conductor removal via operating tool
- Just 2.7 mm tall
- Assemble terminal blocks without pole loss
- Available in tape-and-reel packaging for automated assembly

Notes	
Note	<p>Application notes:</p> <p>Suitable for lead-free, reflow-soldering profiles per DIN EN 61760-1 and IEC 60068-2-58 up to max. 260°C peak temperature. Due to application-specific variables (component configuration and orientation, type of soldering machine, solder paste), trial runs are recommended to ensure product and process compatibility under actual manufacturing conditions.</p> <p>Depending on reflow soldering temperatures and times, color deviations may occur. These deviations will have no impact on functionality.</p>
Recommendation	<p>Recommendation for stencil:</p> <p>150 µm material thickness; Pattern layout identical to solder pad layout</p>



Electrical data			
Ratings per IEC/EN		Ratings per UL 1977	
Ratings per	IEC/EN 60664-1	Rated voltage (UL 1977)	250 V
Nominal voltage (III/3)	63 V	Rated current UL 1977	3 A
Rated impulse voltage (III/3)	2.5 kV		
Rated voltage (III/2)	160 V		
Rated impulse voltage (III/2)	2.5 kV		
Nominal voltage (II/2)	320 V		
Rated surge voltage (II/2)	2.5 kV		
Rated current	3 A		
Legend (ratings)	(III / 2) Δ Overvoltage category III / Pollution degree 2		

Connection data			
Connection points	2	Connection 1	
Total number of potentials	2	Connection technology	PUSH WIRE®
Number of connection types	1	Actuation type	Operating tool
Number of levels	1	Solid conductor	0.14 ... 0.34 mm² / 26 ... 22 AWG
		Note (conductor cross-section)	For conductors (26 AWG) that are not rigid enough, the clamping unit must be opened using an operating tool.
		Strip length	4 ... 5.5 mm / 0.16 ... 0.22 inches
		Conductor connection direction to PCB	0 °
		Pole number	2

Connection 2	
Solid conductor 2	0.5 mm² / 20 AWG
Note (conductor cross-section) 2	No reconnection of smaller conductor cross-sections (0.5 mm²/20 AWG)
Strip length 2	6 ... 7.5 mm / 0.24 ... 0.3 inches

Physical data	
Pin spacing	3 mm / 0.118 inches
Width	5.9 mm / 0.232 inches
Height	2.7 mm / 0.106 inches
Depth	7.9 mm / 0.311 inches
Reel diameter of tape-and-reel packaging	330 mm
Tape width	16 mm

Plug-in connection	
Plugging without loss of pin spacing	Yes



PCB contact	
PCB contact	SMD
Solder pin arrangement	over the entire terminal strip (in-line)
Number of solder pins per potential	2

Material Data	
Note (material data)	Information on material specifications can be found here
Color	white
Material group	I
Insulation material	Polyphthalamide (PPA GF)
Flammability class per UL94	V0
Contact material	Copper alloy
Contact plating	Tin
Fire load	0.002 MJ
Weight	0.2 g

Environmental requirements	
Limit temperature range	-60 ... +105 °C

Commercial data	
Product Group	33 (SMT Terminal)
eCl@ss 10.0	27-14-11-06
eCl@ss 9.0	27-14-11-06
ETIM 8.0	EC001284
ETIM 7.0	EC001284
PU (SPU)	21000 (1750) pcs
Packaging type	Box
Country of origin	CH
GTIN	4055143082686
Customs tariff number	85369010000

Approvals / Certificates	
General approvals	



Approval	Standard	Certificate Name
CCA DEKRA Certification B.V.	EN 60947	NTR NL-7819
CCA DEKRA Certification B.V.	EN 60947	71-111131
CCA DEKRA Certification B.V.	EN 60838	NTR NL-7720
KEMA/KEUR DEKRA Certification B.V.	EN 60838	71-106226
UL Underwriters Laboratories Inc.	UL 1977	E45171



Downloads

Environmental Product Compliance

Compliance Search

Environmental Product Compliance
2059-302/998-403

↓

Documentation

Additional Information

Technical Section
03.04.2019
pdf
1949.09 KB

↓

CAD/CAE-Data

CAD data
2D/3D Models
2059-302/998-403

↓

CAE data
ZUKEN Portal
2059-302/998-403

↓

1 Compatible Products

1.1 Optional Accessories

1.1.1 Board-to-board link

1.1.1.1 Board-to-board link



Item No.: 2059-902
Board-to-Board Link; Pin spacing 3 mm;
2-pole; Length: 15.3 mm; white



Item No.: 2059-902/018-000
Board-to-Board Link; Pin spacing 3 mm;
2-pole; Length: 17.5 mm; white



Item No.: 2059-902/021-000
Board-to-Board Link; Pin spacing 3 mm;
2-pole; Length: 20.5 mm; white

1.1.2 Tool

1.1.2.1 Operating tool

Item No.: 206-859
Operating tool; for 2059 Series; multicoloured

Item No.: 2059-189
Operating tool; made of insulating material; for 2059 Series

Installation Notes

Conductor termination



Conductor termination

