

SECUPRO MARTEGO  
NO. 122001.02

**For highest demands.**  
A cutting tool in which function and design go hand in hand? Meet the SECUPRO MARTEGO, our prize winning squeeze-grip safety knife with fully automatic blade retraction. Get used to the word "very" in its presence: it's very safe, very robust, very ergonomic, very versatile, and made to very high standards. This knife is not only suitable for both right and left-handed users, but also for those with larger hands.



Videos



**Perfect handling**  
The advantages of the SECUPRO MARTEGO lie in your hands. The ergonomic squeeze-grip, the soft grip for better handling, the "pre-set" cutting edge; these three factors guarantee an ergonomic experience.



**Change safely**  
When you need to change the blade, you can do so without any additional tools. Here, the "attraction" of the SECUPRO MARTEGO is revealed: the integrated magnet ensures that the blade cannot fall out.



**Everything under control**  
It's all about aluminium. The powder-coated metal body does not only contribute to the SECUPRO MARTEGO's extraordinary design. It credits the safety knife with extreme robustness and durability.



**Blade lock for extra protection**  
Your SECUPRO MARTEGO accompanies you on your job at every cut and turn? Glad to hear it. But always press the blue blade lock when you've finished cutting! This way the blade cannot make a surprise appearance.



**4-cutting edge blade**  
The Solingen quality blade, with its four sharp edges, can be rotated multiple times. It's worth it! In the meantime, a relatively small cutting depth protects your goods from unnecessary damage.

Application

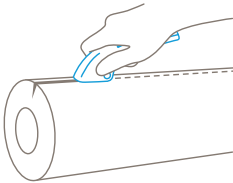
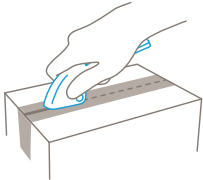
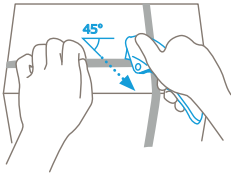
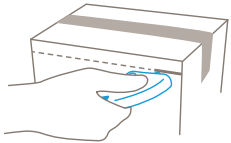

PRODUCT FEATURES NO. 122001.02

Technical features



Main cutting materials



» all cutting materials from page 117 onwards

PRODUCT DETAILS

|                                   |                    |
|-----------------------------------|--------------------|
| Knife size (L x W x H)            | 155 x 18 x 48.5 mm |
| Main material                     | Aluminium          |
| Weight                            | 105.0 g            |
| Weight per unit (single unit box) | 124.0 g            |

ACCESSORIES

ORDER NO.

|  |   |               |
|--|---|---------------|
|  | BELT HOLSTER M WITH CLIP                | NO. 9921.08   |
|  | USED BLADE CONTAINER                    | NO. 9810.08   |
|  | WALL MOUNT BRACKET USED BLADE CONTAINER | NO. 9845.06   |
|  | SAFEBOX                                 | NO. 108000.00 |

» further information from page 107 onwards



You can now also use a ceramic blade as an alternative to the installed steel blade. For the SECUPRO MARTEGO, this is the new CERAMIC BLADE NO. 92C.

ALL MODELS

|  |  |                            |
|--|--|----------------------------|
|  | SECUPRO MARTEGO with INDUSTRIAL BLADE NO. 92<br>1 in single unit box (10 in multipack) | ORDER NO.<br>NO. 122001.02 |
|--|--|----------------------------|

MOUNTABLE BLADES

ORDER NO.

|  |   |              |
|--|---|--------------|
|  | INDUSTRIAL BLADE NO. 92<br>0.40 mm, 10 in safety dispenser                        | NO. 92.66    |
|  | CERAMIC BLADE NO. 92C<br>0.50 mm, ceramic, 2 on self-service card                 | NO. 1792.25  |
|  | INDUSTRIAL BLADE NO. 192<br>0.40 mm, stainless, 10 in safety dispenser            | NO. 192.66   |
|  | INDUSTRIAL BLADE NO. 60092<br>0.40 mm, rounded blade tips, 10 in safety dispenser | NO. 60092.66 |