

Flush-type connector - SACC-E-M12MST-4CON-M16/0,5



1424140

<https://www.phoenixcontact.com/pc/products/1424140>

Please be informed that the data shown in this PDF document is generated from our Online Catalog. Please find the complete data in the user documentation. Our General Terms of Use for Downloads are valid.



Flush-type connector, Power, 4-position, Plug, M12, T power, Front mounting, M16 x 1.5, Individual wires, cable length: 0.5 m, 1.31 mm², UL/cUL stranded hook-up wire

Your advantages

- For compact devices: transmit high power in a confined space
- Pre-assembled with litz wires for immediate use
- Customer-specific assemblies and litz wire lengths available
- Sealed on the litz wire side for optimum leak-tightness
- For high transmission safety: shield connection to the housing with optional EMC nut

Flush-type connector - SACC-E-M12MST-4CON-M16/0,5



1424140

<https://www.phoenixcontact.com/pc/products/1424140>

Commercial Data

Item number	1424140
Packing unit	1 pc
Minimum order quantity	1 pc
Note	Made to Order (non-returnable)
Product Key	ABQEAA
Catalog Page	Page 282 (C-2-2019)
GTIN	4046356693424
Weight per Piece (including packing)	47.2 g
Weight per Piece (excluding packing)	46 g
Customs tariff number	85366990
Country of origin	DE

Flush-type connector - SACC-E-M12MST-4CON-M16/0,5



1424140

<https://www.phoenixcontact.com/pc/products/1424140>

Technical Data

Notes

Notes on operation	The electrical and mechanical data specified assume that the connector pair is correctly locked and mounted. If the connector is unlocked and if there is a danger of contamination, the connector must be sealed using a protective cap > IP54. Influences arising from litz wires, cables or PCB assembly must also be taken into consideration.
--------------------	--

Product properties

Product type	Circular connectors (device side)
Number of positions	4
No. of cable outlets	1
Shielded	no
Coding	T power

Insulation characteristics

Overvoltage category	III
Degree of pollution	3

Ambient conditions

Degree of protection	IP67
Degree of protection	IP65/IP67
Ambient temperature (operation)	-25 °C ... 85 °C (Plug / socket)
	-40 °C ... 85 °C (without mechanical actuation)
	-25 °C ... 105 °C (Cable, flexible installation)
	-40 °C ... 105 °C (cable, fixed installation)

Connector

Insertion/withdrawal cycles	> 100
-----------------------------	-------

Header 1

Head design	Plug
Head thread type	M12
Coding	T power

Electrical properties

Rated surge voltage	1.5 kV
Rated surge voltage	1.5 kV AC/DC
Contact resistance	≤ 3 mΩ
Insulation resistance	≥ 100 MΩ
Nominal voltage U_N	63 V DC
Nominal current I_N	12 A
Test voltage	1.5 kV

Flush-type connector - SACC-E-M12MST-4CON-M16/0,5



1424140

<https://www.phoenixcontact.com/pc/products/1424140>

Material specifications

Material	PU 2K (Grout material)
Flammability rating according to UL 94	V0
Sealing material	FKM
Contact material	CuZn
Contact surface material	Au
Contact carrier material	PA
Cable gland material	CuZn alloy, nickel-plated

Connection data

Conductor connection

Connection method	Individual wires
-------------------	------------------

Mounting

Mounting type	Front mounting
---------------	----------------

Standards and regulations

Flame resistance	in acc. to UL 1581 VW1
------------------	------------------------

M12

Standards/specifications	IEC 61076-2-111
--------------------------	-----------------

Cable / line

Cable length	0.5 m
--------------	-------

Cable structure

Cable type	UL/cUL stranded hook-up wire
Signal type/category	Power
Conductor material	Bare Cu litz wires
AWG signal line	16
Material wire insulation	mPPE
Wire diameter incl. insulation	2 mm
Single wire, color	Black, brown, blue, white

Ambient conditions

Halogen-free	yes
Flame resistance	in acc. to UL 1581 VW1
Ambient temperature (operation)	-25 °C ... 105 °C (Cable, flexible installation)
	-40 °C ... 85 °C (without mechanical actuation)
	-40 °C ... 85 °C (without mechanical actuation)

Flush-type connector - SACC-E-M12MST-4CON-M16/0,5

1424140

<https://www.phoenixcontact.com/pc/products/1424140>

Drawings

Circuit diagram

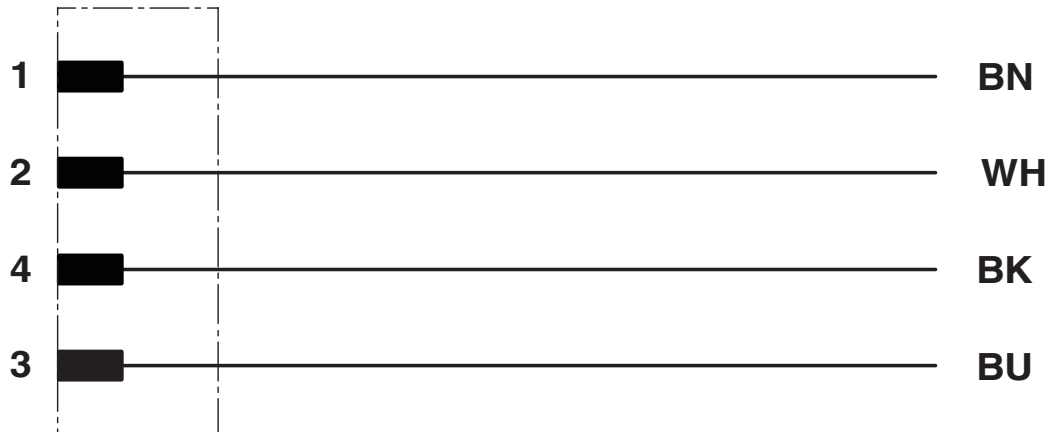

Contact assignment of the M12 plug

Dimensional drawing

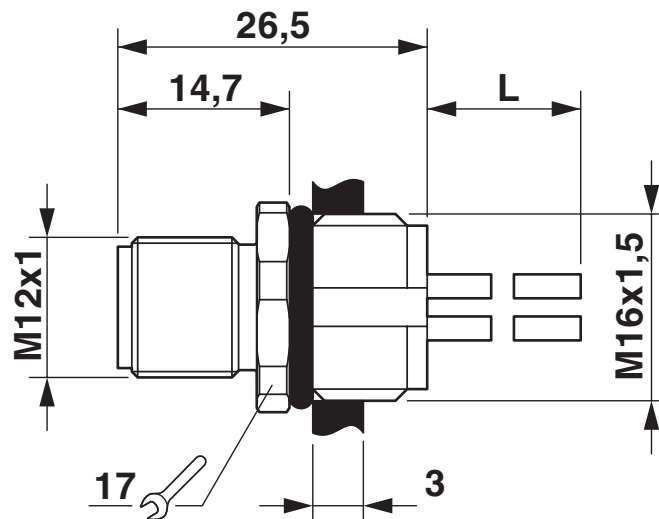

M12 flush-type plug

Flush-type connector - SACC-E-M12MST-4CON-M16/0,5

1424140

<https://www.phoenixcontact.com/pc/products/1424140>

Schematic diagram

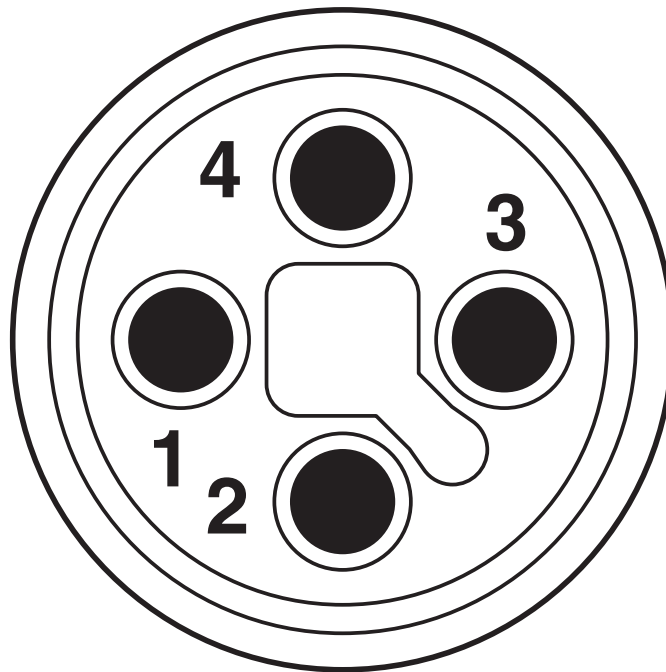

Connector pin assignment of M12 plug, 4-pos., T-coded, view of pin side

Flush-type connector - SACC-E-M12MST-4CON-M16/0,5



1424140

<https://www.phoenixcontact.com/pc/products/1424140>

Approvals



EAC

Approval ID: B.01687

Flush-type connector - SACC-E-M12MST-4CON-M16/0,5



1424140

<https://www.phoenixcontact.com/pc/products/1424140>

Classifications

ECLASS

ECLASS-9.0	27440102
ECLASS-10.0.1	27440102
ECLASS-11.0	27440102

ETIM

ETIM 8.0	EC002635
----------	----------

UNSPSC

UNSPSC 21.0	39121400
-------------	----------

Flush-type connector - SACC-E-M12MST-4CON-M16/0,5



1424140
<https://www.phoenixcontact.com/pc/products/1424140>

Environmental Product Compliance

REACH SVHC	Lead 7439-92-1
China RoHS	Environmentally Friendly Use Period = 50 years
	For information on hazardous substances, refer to the manufacturer's declaration available under "Downloads"

Flush-type connector - SACC-E-M12MST-4CON-M16/0,5



1424140

<https://www.phoenixcontact.com/pc/products/1424140>

Accessories

Flat nut

Flat nut - SACC-E-MU-M16 - 1504097

<https://www.phoenixcontact.com/pc/products/1504097>

Flat nut with M16 thread



Phoenix Contact 2022 © - all rights reserved
<https://www.phoenixcontact.com>

PHOENIX CONTACT GmbH & Co. KG
Flachmarktstraße 8
D-32825 Blomberg
+49 (0) 5235-3 00
info@phoenixcontact.com