

EPIC® H-B 6 TBFH-LB

Housing design H-B. The industry standard.

The robust high metal housing has a direct cable entry and is suitable for use with inserts with outstanding electrical properties.

Info

More interior space for wiring

Protection rating UL50E tested

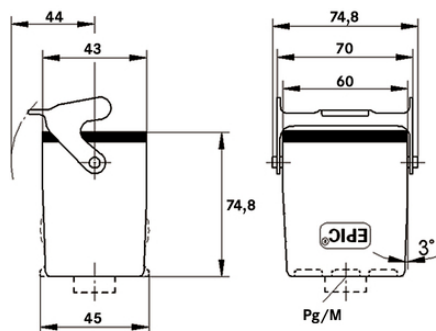

Supplementary automation components from Lapp



Mechanical and plant engineering



Mechanical resistance



Robust



Waterproof

Benefits

The smallest housing out of the H-B series. For inserts with high electrical properties

Application range

Plant engineering

Control engineering

Plastics industry

Product features

Cable coupler hood, high version

Last Update (06.09.2020)

©2020 Lapp Group - Technical changes reserved

Product Management www.lappkabel.de

You can find the current technical data in the corresponding data sheet.

PN 0456 / 02_03.16

EPIC® H-B 6 TBFH-LB

Single lever
Straight cable entry
Versions with / without neck

Technical Data

Classification ETIM 5:	ETIM 5.0 Class-ID: EC000437 ETIM 5.0 Class-Description: Housing for industrial connectors
Classification ETIM 6:	ETIM 6.0 Class-ID: EC000437 ETIM 6.0 Class-Description: Housing for industrial connectors
Material:	Housing: powder-coated aluminium alloy, grey Lever: zinc-plated steel Sealing: NBR
Protection rating:	IP 65 (latched) NEMA 250, UL50E: 12, 4 (latched)
VDE-tested:	Certified production control: VDE-REG. no.: B437 UL-tested: UL File Number: E75770
Temperature range:	-40°C to +100°C, short-term up to +125°C

Note

Photographs and graphics are not to scale and do not represent detailed images of the respective products.
Prices are net prices without VAT and surcharges. Sale to business customers only.

EPIC® H-B 6 TBFH-LB

Article number	Article description	M	PG	Neck	Pieces / PU
H-B housing: cable coupler hood (1 straight cable entry, single lever, high version)					
70010200	H-B 6 TBFH 21	-	21	yes	10
70010400	H-B 6 TBFH 29	-	29	yes	10
79010200	H-B 6 TBFH M25	25	-	-	10

Last Update (06.09.2020)

©2020 Lapp Group - Technical changes reserved

Product Management www.lappkabel.de

You can find the current technical data in the corresponding data sheet.

PN 0456 / 02_03.16