

# Panel feed-through - SACC-DSI-M12MS-12CON-M16 SH



1441943

<https://www.phoenixcontact.com/au/products/1441943>

Please be informed that the data shown in this PDF document is generated from our Online Catalog. Please find the complete data in the user documentation. Our General Terms of Use for Downloads are valid.

---



Sensor/actuator flush-type plug, 12-pos. with shield contact, M12 SPEEDCON, A-coded, rear/screw mounting with M16 thread, with straight solder connection

---

## Your advantages

- Easy PCB assembly: one-piece connectors for wave soldering
- All standard pin assignments and codings for signal, data, and power transmission with a uniform design-in design
- SPEEDCON fast locking system reduces cabling times
- For high transmission reliability: optional shield connection to the housing by means of shield contact



# Panel feed-through - SACC-DSI-M12MS-12CON-M16 SH



1441943

<https://www.phoenixcontact.com/au/products/1441943>

## Commercial Data

Item number	1441943
Packing unit	20 pc
Minimum order quantity	20 pc
Sales Key	ABQCAA
Product Key	ABQCAA
Catalog Page	Page 251 (C-2-2013)
GTIN	4046356534161
Weight per Piece (including packing)	15.797 g
Weight per Piece (excluding packing)	15.797 g
Customs tariff number	85366990
Country of origin	DE



# Panel feed-through - SACC-DSI-M12MS-12CON-M16 SH



1441943

<https://www.phoenixcontact.com/au/products/1441943>

## Technical Data

### Notes

Notes on operation	The electrical and mechanical data specified assume that the connector pair is correctly locked and mounted. If the connector is unlocked and if there is a danger of contamination, the connector must be sealed using a protective cap > IP54. Influences arising from litz wires, cables or PCB assembly must also be taken into consideration.
--------------------	----------------------------------------------------------------------------------------------------------------------------------------------------------------------------------------------------------------------------------------------------------------------------------------------------------------------------------------------------

### Product properties

Product type	Circular connectors (device side)
Number of positions	12
Shielded	yes
Coding	A - standard

### Insulation characteristics

Overvoltage category	II
Degree of pollution	3

### Ambient conditions

Degree of protection	IP67 (When plugged in)
	IP65 (When plugged in)
Degree of protection	IP65/IP67
Ambient temperature (operation)	-25 °C ... 85 °C (Plug / socket)
	-40 °C ... 85 °C (without mechanical actuation)
	-25 °C ... 85 °C (Cable, flexible installation)
	-40 °C ... 85 °C (cable, fixed installation)

### Dimensions

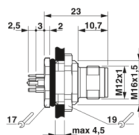
Dimensional drawing	
Length of the solder pin	6 mm
	6 mm

### Connector

Insertion/withdrawal cycles	> 100
-----------------------------	-------

### Header 1

Head thread type	M12
------------------	-----

### Electrical properties

Rated surge voltage	0.8 kV
---------------------	--------



# Panel feed-through - SACC-DSI-M12MS-12CON-M16 SH



1441943

<https://www.phoenixcontact.com/au/products/1441943>

Contact resistance	$\leq 3 \text{ m}\Omega$
Insulation resistance	$\geq 100 \text{ M}\Omega$
Nominal voltage $U_N$	30 V
Nominal current $I_N$	1.5 A

## Material specifications

Flammability rating according to UL 94	V0
Sealing material	FKM
Contact material	CuZn
Contact surface material	Au
Contact carrier material	PA 6.6
Cable gland material	Zinc die-cast, nickel-plated

## Connection data

### Conductor connection

Connection method	Solder pins
-------------------	-------------

## Mounting

Mounting type	Rear mounting M16 x 1.5 With flat nut
Assembly instructions	With flat nut

## Standards and regulations

### M12

Standards/specifications	IEC 61076-2-101
--------------------------	-----------------

## Cable / line

### Ambient conditions

Ambient temperature (operation)	-25 °C ... 85 °C (Cable, flexible installation)
	-40 °C ... 85 °C (cable, fixed installation)



# Panel feed-through - SACC-DSI-M12MS-12CON-M16 SH

1441943

<https://www.phoenixcontact.com/au/products/1441943>

## Drawings

Dimensional drawing

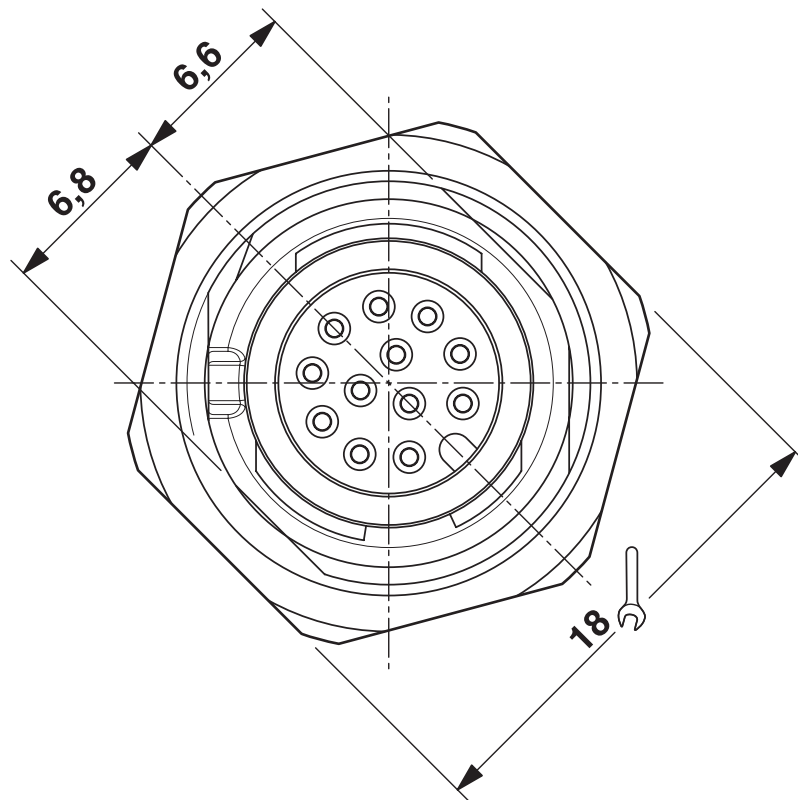

M12 front view

Drilling plan/solder pad geometry

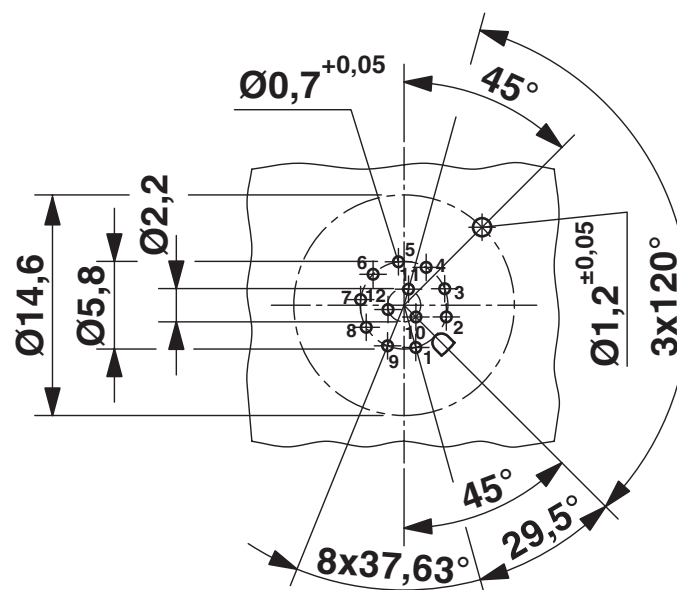



# Panel feed-through - SACC-DSI-M12MS-12CON-M16 SH

1441943

<https://www.phoenixcontact.com/au/products/1441943>

Dimensional drawing

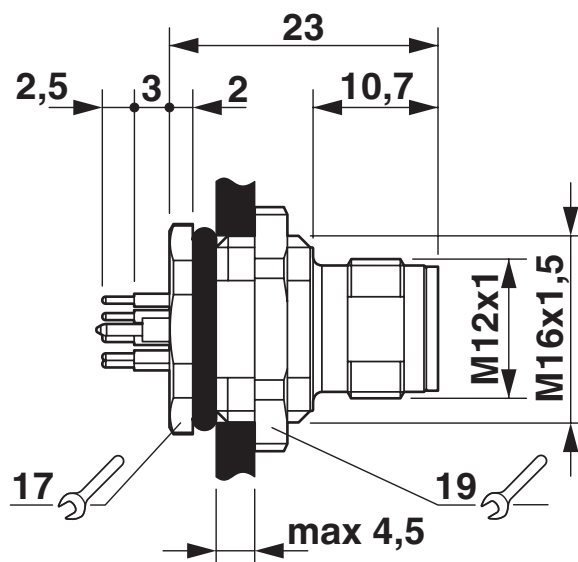

Schematic diagram

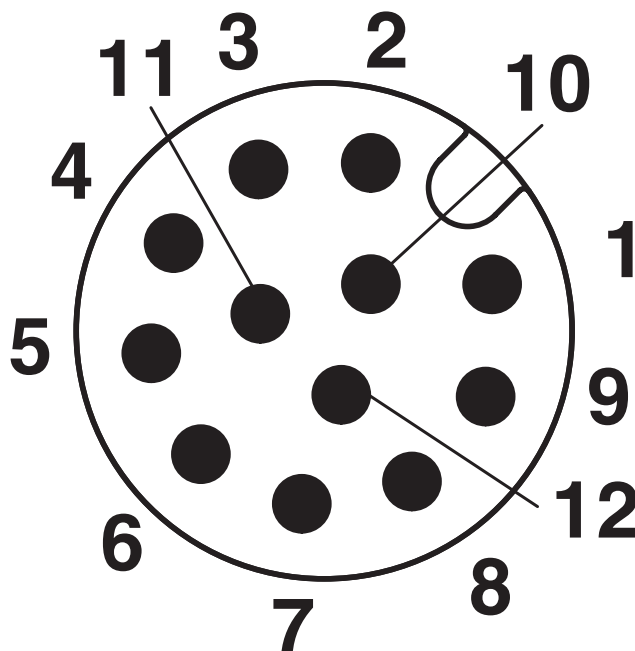

Pin assignment M12 male connector, 12-pos., male side view



# Panel feed-through - SACC-DSI-M12MS-12CON-M16 SH



1441943

<https://www.phoenixcontact.com/au/products/1441943>

Dimensional drawing

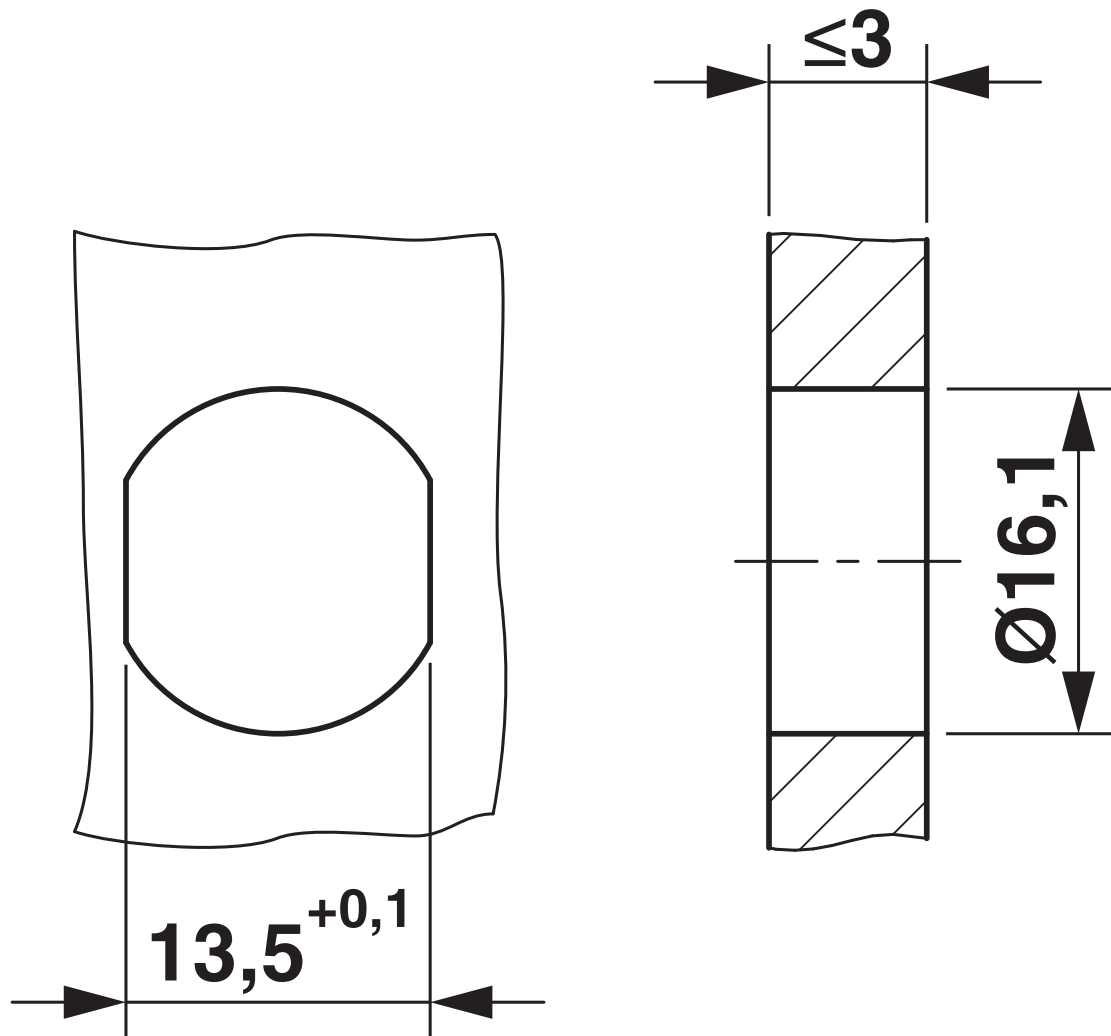

Housing cutout for M16 fastening thread, mounting panel with feed-through hole (alternatively with area as anti-rotation protection for panel thicknesses > 2 mm up to max. 4.5 mm)



# Panel feed-through - SACC-DSI-M12MS-12CON-M16 SH



1441943

<https://www.phoenixcontact.com/au/products/1441943>

## Approvals



### UL Recognized

Approval ID: FILE E 118976

	Nominal Voltage $U_N$	Nominal Current $I_N$	Cross Section AWG	Cross Section $\text{mm}^2$
	30 V	1.5 A	- 26	-



### EAC

Approval ID: B.01687



### cULus Recognized

Approval ID: E221474-20140616

	Nominal Voltage $U_N$	Nominal Current $I_N$	Cross Section AWG	Cross Section $\text{mm}^2$
	30 V	1.5 A	- 26	-



# Panel feed-through - SACC-DSI-M12MS-12CON-M16 SH



1441943

<https://www.phoenixcontact.com/au/products/1441943>

## Classifications

### ECLASS

ECLASS-9.0	27440102
ECLASS-10.0.1	27440102
ECLASS-11.0	27440102

### ETIM

ETIM 8.0	EC002635
----------	----------

### UNSPSC

UNSPSC 21.0	39121400
-------------	----------



# Panel feed-through - SACC-DSI-M12MS-12CON-M16 SH



1441943  
<https://www.phoenixcontact.com/au/products/1441943>

## Environmental Product Compliance

REACH SVHC	Lead 7439-92-1
China RoHS	Environmentally Friendly Use Period = 50 years
	For information on hazardous substances, refer to the manufacturer's declaration available under "Downloads"



# Panel feed-through - SACC-DSI-M12MS-12CON-M16 SH



1441943

<https://www.phoenixcontact.com/au/products/1441943>

## Accessories

### Flat gasket

Flat gasket - SACC-M16-SEAL CLM - 1430394

<https://www.phoenixcontact.com/au/products/1430394>

M16 flat gasket for M12 flush-type connectors with M16 fastening thread



---

### Sealing cap

Sealing cap - PROT-M12 FS - 1560251

<https://www.phoenixcontact.com/au/products/1560251>

M12 sealing cap for unoccupied M12 plugs of the sensor/actuator cable, flush-type plugs and I/O devices in the field





# Panel feed-through - SACC-DSI-M12MS-12CON-M16 SH



1441943

<https://www.phoenixcontact.com/au/products/1441943>

## Sealing cap

Sealing cap - PROT-M12 FS-M - 1430488

<https://www.phoenixcontact.com/au/products/1430488>



M12 metal sealing cap for unoccupied M12 plugs of the sensor/actuator cable, flush-type plugs and I/O devices in the field

---

Phoenix Contact 2022 © - all rights reserved

<https://www.phoenixcontact.com>

PHOENIX CONTACT PTY Ltd

Unit 7, 2-8 South Street

Rydalmere NSW 2116

1300 786 411

[customerservice@phoenixcontact.com.au](mailto:customerservice@phoenixcontact.com.au)