

Switch Probes

www.feinmetall.com

Centers 2,54 mm/100 mil

Type	Switch Travel	Temperature
F875	1,5 mm	-20°...+80°C

Switch Probe (NO) for Presence Testing

F875



The F875 is screwed into the corresponding receptacle to prevent ejection and to adjust variable projection heights.

For solder free replacement use receptacle H875KB or H875KB/5.

Mechanical Specifications

Switch Travel: 1,5 ± 0,2 mm

Working Travel: 4,0 mm

Full Travel: 5,0 mm

Preload (cN):	20	30	60
Spring Force (cN) at Working Travel: (±20%)	80	135	200
Preload (cN):	60	80	
Spring Force (cN) at Working Travel: (±20%)	300	350	

Pointing Accuracy: ± 0,08 mm

Electrical Specifications

Maximum switching current: 1,0 A

Maximum continuous current: 5,0 A

Typical switch resistance: 65 mOhm

Materials and Finishes

Plunger: Beryllium copper (BeCu),

Gold plated / Synthetic unplated

Barrel: Brass, Gold plated

Spring: Music wire, Silver plated

Receptacle: Brass, Gold plated

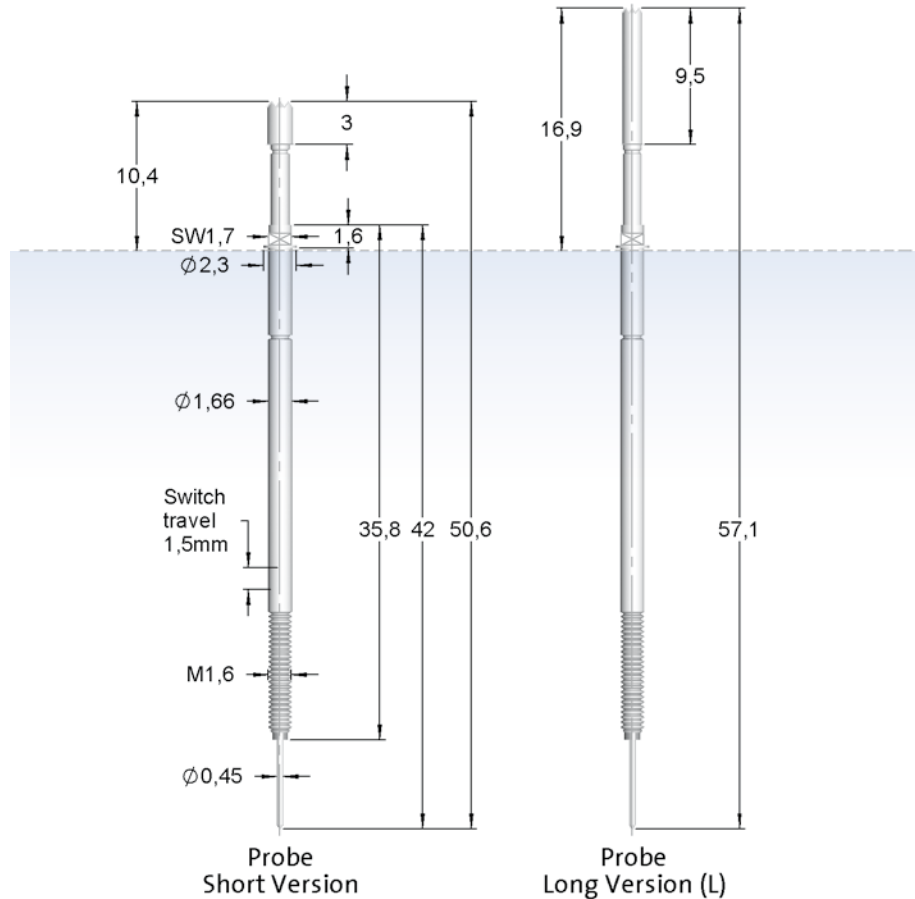

Projection Height	H875/H875KB	H875IS*	H875/5	H875KB/5
Standard Version	10,4 - 15,4 mm	10,6 - 15,6 mm	15,2 - 20,2 mm	15,2 - 20,2 mm
Long Version	16,9 - 21,9 mm	17,1 - 22,1 mm	21,7 - 26,7 mm	21,7 - 26,7 mm

*in combination with H875 / H875KB All available receptacles on page 47

Switch Insulator:
Synthetic Material
(maximum 300°C)

Plunger Tip Style, Material, Finish and Tip Diameter (mm)



05 BeCu; G ø 1,8	06 BeCu; G ø 1,3 / 1,5 / 1,8 / 2,0 / 2,3	06 BeCu; G L-Version ø 1,0 / 1,4 / 1,8	11 BeCu; G ø 0,64 / 1,0	11 BeCu; G L-Version ø 1,0
----------------------------	--	---	-----------------------------------	---



16 BeCu; G ø 0,64 / 0,7 / 0,8 / 1,0	16 BeCu; G L-Version ø 1,0	17 BeCu; G ø 1,8	17 Synthetic; U ø 1,8 / 2,3	
---	---	----------------------------	---------------------------------------	--

Type	Tip Diameter	Spring Force	
F875	06B 180	G 135 L	
Tip Style	Material	Finish	
		Length	
Material:	B = BeCu, K = Synthetic		
Tip Diameter:	1,80 mm = 180 (e.g.)		
Finish:	G = Gold plated, U = Unplated		
Length:	L = Long Version		
Receptacle:	Order Number see list Projection Height		
ORDER EXAMPLE			

Receptacles for Switch Probes Series F875 and F873 H875

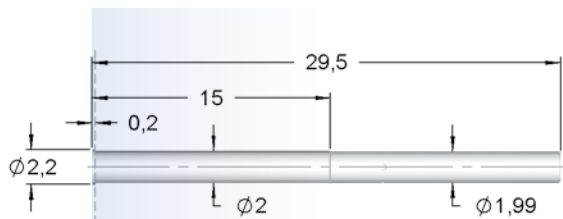

Receptacle
H875

Standard Receptacle H875

This receptacle in combination with F875 or F873 allows adjustable range of projection height.

Projection Height:

Standard Version: 10,4 - 15,4 mm
Long Version (L): 16,9 - 21,9 mm

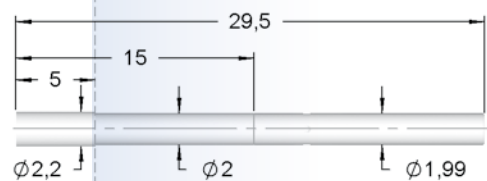

Receptacle
H875/5

Standard Receptacle H875/5

The receptacle H875/5 can be used, if a greater projection height is needed than it is viable with the H875.

Projection Height:

Standard Version: 15,2 - 20,2 mm
Long Version (L): 21,7 - 26,7 mm

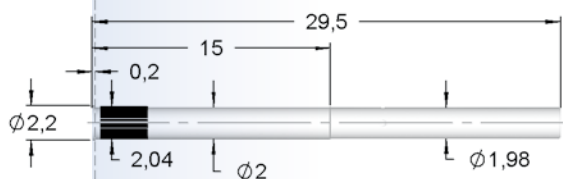

Receptacle
H875RD

Knurled Receptacle H875RD

H875RD is compatible to H875 but knurled for a secure fitting.

Projection Height:

Standard Version: 10,4 - 15,4 mm
Long Version (L): 16,9 - 21,9 mm

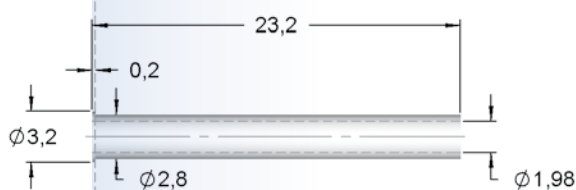

Receptacle
H875IS

Insulating Receptacle H875IS

The insulating receptacle H875IS allows applications (in combination with receptacles H875 or H875KB optional also H875/5 or H875KB/5) in conductive materials, e.g. steel.

Projection Height:

Standard Version: 10,6 - 15,6 mm
Long Version (L): 17,1 - 22,1 mm

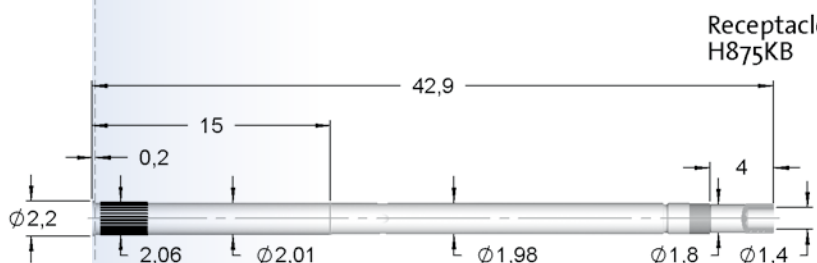

Receptacle
H875KB

Solder free replacement H875KB

This receptacle is developed for solder free replacement of switch probes. The probes are height adjustable in combination with KB-Receptacles. Max. temp. 300°C.

Projection Height:

Standard Version: 10,4 - 15,4 mm
Long Version (L): 16,9 - 21,9 mm

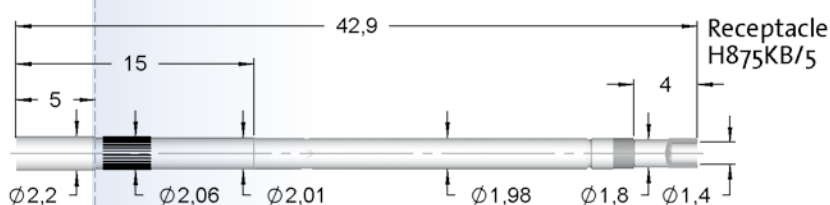

Receptacle
H875KB/5

Solder free replacement H875KB/5

H875KB/5 is compatible to H875KB but with collar height 5 mm. Max. temp. 300°C.

Projection Height:

Standard Version: 15,2 - 20,2 mm
Long Version (L): 21,7 - 26,7 mm