

Inrush current limiter **ESG 2**



Picture shows ESG 2

Advantages

Very good moisture protection thanks to XtraDenseFill resin encapsulation

May be used anywhere for stationary and mobile applications

ESG 1: Integrated safety plug and built-in safety socket

ESG 2: 1.4 m connecting cable with safety plug and built-in safety socket

Applications

Inrush current limiting option for limiting the inrush current in transformers with high switch-on or inrush currents (not suited for electrical machinery or motors).

Approvals



Inrush current limiter ESG 2

Electrical data

Type	ESG 2
Operating data	
Rated voltage	220 - 250 Vac
Rated frequency	50 - 60 Hz
Rated current	max. 16 A
Environment	
Ambient temperature max.	40 °C
Safety and protection	
Safety	integrated, non-replaceable thermal fuse in the input circuit
Type	Resin encapsulated transformer
Protection index	IP 20
Safety class (prepared)	I
Internal impedance	3.75 Ω
Order numbers	
Order Number	ESG 2

Mechanical data

Type	ESG 2
Terminal and mounting	
Terminals Input	Mains connecting cable with safety plug
Terminals Output	Safety socket
Measures and weights	
Weight	0.55 kg

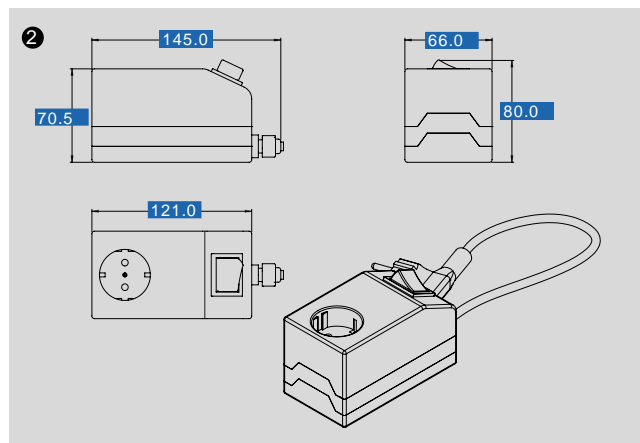

Subject to change.