

Data Sheet | Item Number: 2092-1108/002-000
1-conductor female connector; push-button; Push-in CAGE CLAMP®; 2.5 mm²; Pin spacing 5 mm; 8-pole; Gripping plate sliding connector release; 2,50 mm²; light gray



<https://www.wago.com/2092-1108/002-000>



Color: light gray

Similar to illustration

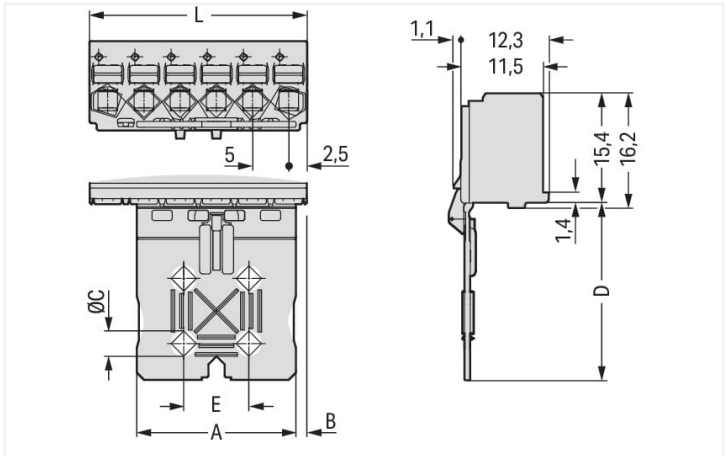

Dimensions in mm

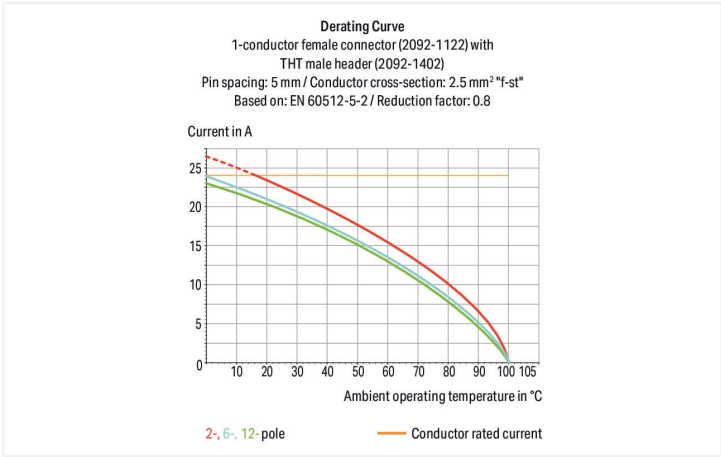

- Universal connection of all conductor types
- Simple, push-in termination of solid and ferruled conductors
- Easy-to-use design does not require special tools
- Ability to wire while mated or unmated
- Testing parallel to conductor entry – tip contact
- Also available with gripping plates
- Integrated locking latches prevent accidental disconnection

Notes	
Safety information 1	The picoMAX® Pluggable Connection System includes connectors without breaking capacity in accordance with DIN EN 61984. When used as intended, these connectors must not be connected/disconnected when live or under load. The circuit design should ensure header pins, which can be touched, are not live when unmated.

Variants:	Direct marking Other versions (or variants) can be requested from WAGO Sales or configured at https://configurator.wago.com/ .
-----------	--



Electrical data			
Ratings per IEC/EN		Ratings per UL 1059	
Ratings per	IEC/EN 60664-1	Approvals per	UL 1059
Nominal voltage (III/3)	250 V	Rated voltage UL (Use Group B)	300 V
Rated impulse voltage (III/3)	4 kV	Rated current UL (Use Group B)	15 A
Rated voltage (III/2)	320 V	Rated voltage UL (Use Group D)	300 V
Rated impulse voltage (III/2)	4 kV	Rated current UL (Use Group D)	10 A
Nominal voltage (II/2)	630 V		
Rated surge voltage (II/2)	4 kV		
Rated current	16 A		
Legend (ratings)	(III / 2) \triangle Overvoltage category III / Pollution degree 2		

Connection data			
Connection points	8	Connection 1	
Total number of potentials	8	Connection technology	Push-in CAGE CLAMP®
Number of connection types	1	Actuation type	Push-button
Number of levels	1	Solid conductor	0.2 ... 2.5 mm² / 24 ... 12 AWG
		Fine-stranded conductor	0.2 ... 2.5 mm² / 24 ... 12 AWG
		Fine-stranded conductor; with insulated ferrule	0.25 ... 1.5 mm²
		Fine-stranded conductor; with uninsulated ferrule	0.25 ... 2.5 mm²
		Strip length	9 ... 10 mm / 0.35 ... 0.39 inches
		Pole number	8

Physical data		
Pin spacing	5 mm / 0.197 inches	
Width	40 mm / 1.575 inches	
Height	40.4 mm / 1.591 inches	
Depth	14.4 mm / 0.567 inches	

Mechanical Data		
Variable coding	Yes	
Design	with gripping plate and sliding connector release	
Anti-rotation protection	Yes	

Plug-in connection		
Contact type (pluggable connector)	Female connector/socket	
Connector (connection type)	for conductor	
Mismating protection	No	
Plugging without loss of pin spacing	Yes	



Material Data	
Note (material data)	Information on material specifications can be found here
Color	light gray
Material group	I
Insulation material	Polyphthalamide (PPA GF)
Flammability class per UL94	V0
Clamping spring material	Chrome-nickel spring steel (CrNi)
Contact material	Electrolytic copper (E _{Cu})
Contact plating	Tin
Fire load	0.04 MJ
Weight	7.9 g

Environmental requirements	
Limit temperature range	-60 ... +100 °C
Processing temperature	-35 ... +60 °C

Commercial data	
eCl@ss 10.0	27-14-11-06
eCl@ss 9.0	27-14-11-06
ETIM 8.0	EC001284
ETIM 7.0	EC001284
PU (SPU)	50 pcs
Packaging type	Box
Country of origin	DE
GTIN	4050821411758
Customs tariff number	85366990990

Approvals / Certificates

General approvals



Approval	Standard	Certificate Name
CB DEKRA Certification B.V.	IEC 61984	NL-49737/A1
CSA DEKRA Certification B.V.	C22.2	2362521
CSA DEKRA Certification B.V.	C22.2 No. 158	2362521
cURus Underwriters Laboratories Inc.	UL 1059	E45172
KEMA/KEUR DEKRA Certification B.V.	EN 61984	71-102261 REV.2
UL Underwriters Laboratories Inc.	UL 1977	E45171



Downloads

Environmental Product Compliance

Compliance Search

Environmental Product Compliance
2092-1108/002-000

↓

Documentation

Additional Information

Technical Section
03.04.2019
pdf
1949.09 KB

↓

CAD/CAE-Data

CAD data
2D/3D Models
2092-1108/002-000

↓

CAE data
ZUKEN Portal
2092-1108/002-000

↓

1 Compatible Products

1.1 System counterpart

1.1.1 Male connector/plug



Item No.: [2092-1428](#)
THT male header; 1.4 mm Ø solder pin; angled; Pin spacing 5 mm; 8-pole; light gray



Item No.: [2092-1408](#)
THT male header; 1.4 mm Ø solder pin; straight; Pin spacing 5 mm; 8-pole; light gray

1.2 Optional Accessories

1.2.1 Test and measurement

1.2.1.1 Testing accessories



Item No.: [735-500](#)
WAGO Test pin; 1 mm Ø; 30 V AC / 60 V DC; CAT0; 1 A; 6 mm uninsulated; Test lead for soldering up to 0,5mm²

1.2.2 Tool

1.2.2.1 Operating tool



Item No.: 210-719
Operating tool; Blade: 2.5 x 0.4 mm; with a partially insulated shaft

Installation Notes

Locking system

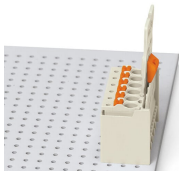

Male header mated to a female connector with gripping plate and sliding connector release.

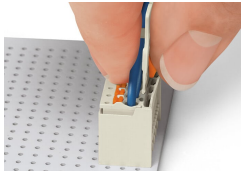

Push down sliding connector release (gripping plate) to open the locking latch.

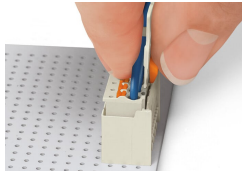

Pull out female connector from male header.

Conductor termination

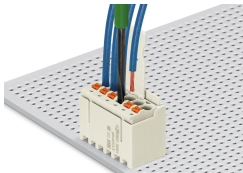

Inserting fine-stranded conductor into mated female connector via push-button.



Inserting a fine-stranded conductor into an unmated female connector via push-button.

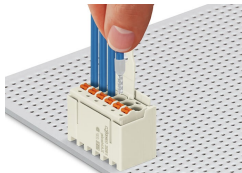

Inserting solid and ferruled conductors via push-in termination.

Marking



Pole marking via factory direct marking.

Coding

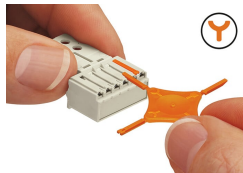

Coding a female connector (via coding key carrier and two keys for female connector, see symbol).

Testing



Testing via 1 mm Ø test pin – touch contact.