

| | |
|---------------------|---|
| Product description | M16 IP40 female panel mount connector, Contacts: 12, shielding is not possible, solder, IP40 |
| Area | M16 IP40 series 680 |
| Order number | 09 0332 00 12 |

Illustration

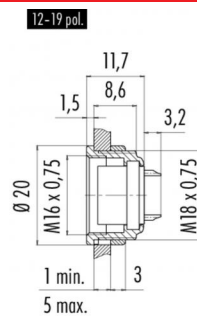

Scale drawing



Contact arrangement

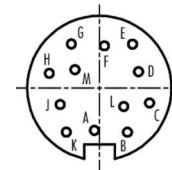

| | X | Y |
|---|-------|-------|
| A | -0,44 | -3,45 |
| B | 2,29 | -3,61 |
| C | 4,10 | -1,21 |
| D | 3,20 | 1,34 |
| E | 2,71 | 3,59 |
| F | 0,41 | 3,45 |
| G | -2,29 | 3,61 |
| H | -4,10 | 1,21 |
| J | -3,20 | -1,34 |
| K | -2,71 | -3,59 |
| L | 2,00 | -1,51 |
| M | -2,00 | 1,51 |

You can find the assembly instructions on the next page.

Technical data

General values

| | |
|--------------------------|------------------------------|
| Connector design | female panel mount connector |
| Connector locking system | screw |
| Termination | solder |
| Wire gauge (mm) | 0.25 mm ² |
| Wire gauge (AWG) | 24 |
| Upper limit temperature | 85 °C |
| Lower limit temperature | -40 °C |
| Customs tariff number | 85369010 |
| Packaging Unit | 20 |

Electrical values

| | |
|---------------------------|---------------------------|
| Rated current (40 °C) | 3 A |
| Rated voltage | 60 V |
| Rated impulse voltage | 500 V |
| Pollution degree | 1 |
| Overvoltage category | I |
| Insulating material group | III |
| Insulation resistance | ≥ 10 ¹⁰ Ω |
| EMC compliance | shielding is not possible |
| Degree of protection | IP40 |
| Mechanical operation | > 500 Mating cycles |

Material

| | |
|-----------------------|-----------------------------|
| Contact material | CuSn (bronze) |
| Contact plating | Au (gold) |
| Contact body material | PBT (UL94 V-0) |
| Housing material | Zinc die-cast nickel-plated |

Product description **M16 IP40 female panel mount connector, Contacts: 12, shielding is not possible, solder, IP40**

Area **M16 IP40 series 680**
Order number **09 0332 00 12**

Assembly instructions / Panel cut-out

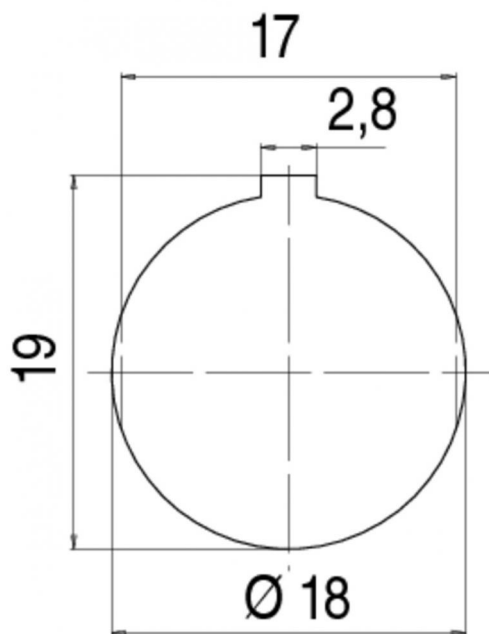

| | |
|---------------------|---|
| Product description | M16 IP40 female panel mount connector, Contacts: 12, shielding is not possible, solder, IP40 |
| Area | M16 IP40 series 680 |
| Order number | 09 0332 00 12 |

Security notices

The connectors are designed for use in plant, control system and electrical equipment. The end user is responsible for checking whether the connectors are suitable for use in other applications.